

Flat pressed straight branch with gasket

ILPL



Description

Flat straight branches are designed for connecting round SPIRAL or plain ducts to the main square ducts. This piece is also used for fabrication of expansion boxes in air supply diffusers and wall-mounted and ceiling air diffusers. As a result of the double EPDM rubber gasket, it is perfect for both low- and high-pressure systems, since the product meets requirements for air tightness class D according to EN12237.

Available materials - Product code example

ILPL-... - galvanized steel sheet

Product code example

Product code: **ILPL - aaa**

type _____
 Ød _____

Dimensions

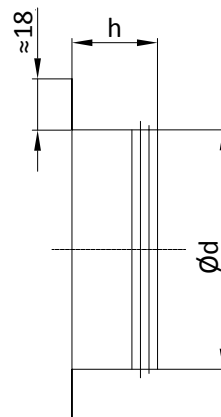

$\varnothing d_{nom}$ [mm]	h [mm]	tolerance [mm]	Weight [kg]
80	42	0 -3	0.10
100	42	0 -3	0.10
125	42	0 -3	0.10
150	42	0 -3	0.10
160	42	0 -3	0.10
200	42	0 -3	0.20